



Front LED Light

Helio 100

TO MOUNT THE LIGHT

1. Instal the bracket onto your handlebar.
2. Slide the light into the bracket until it clicks into place.

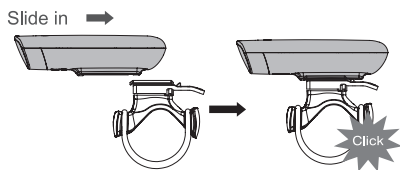

TO REMOVE THE LIGHT

- Press the release tab and slide the light away from the bracket.

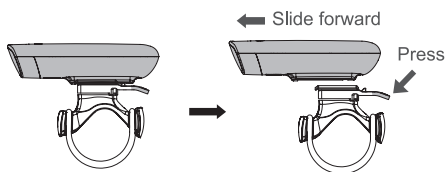

TO INSERT BATTERIES

- To insert batteries, slide backward the cover then insert new 2x AA batteries.

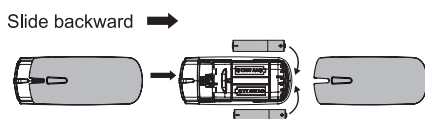

- When the cover aims at the mark „slide“ you should push it forward to the light unit, until they CLICK seal closely.

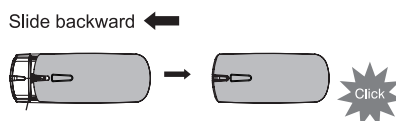

TO SWITCH MODE

- Double click to turn on the light.

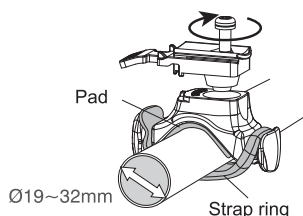
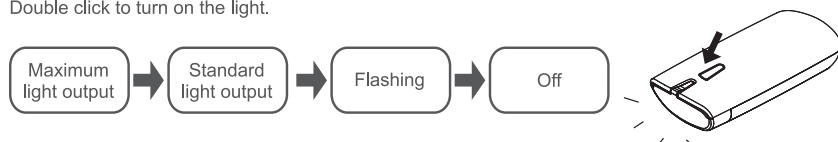

Caution:

- Carrying spare battery will be recommended to prevent from battery shutoff.
- Do not mix dry batteries (primary batteries) and rechargeable batteries.
- For best performance, do not mix new and old batteries.
- We recommend to remove batteries from the light during period of non-use to avoid the battery leakage.
- Carefully install batteries, insuring proper polarity.
- For your own safety, please do not operate the controls of the product while riding.
- 7. Please keep the product out of children's reach.

SPECIFICATIONS

- Size: 89.4 x 37.9 x 23.9 mm
- Weight: 26.6 g (without battery)
- LED: 2 super bright LEDs
- Battery: LR6 (AA) X 2



- DE Anleitung
- FR Mode d'emploi
- ES Instrucciones
- I Istruzioni
- HU Utasítás
- PL Instrukcje
- CZ Návod na použití
- SK Návod na použitie